



Set-up Instructions



# Recoverable Bead Glass Door Bit Set

(26651) 99-280, (25480) 99-281, (24291) 99-283

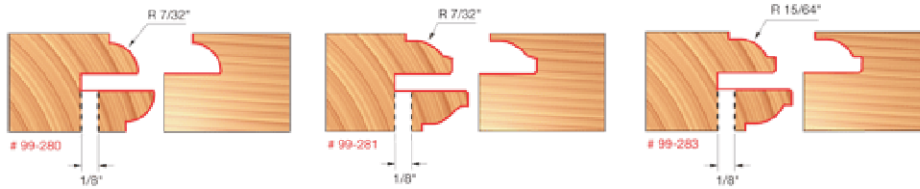

## Step 1

Set up the cope cutter (bearing on top) to match the existing set-up of your current raised panel door. This is usually 1/8" above the surface of the table. (Figure 1) Cut your copes on the end grains of all rail pieces making sure that the good side of your stock is face down.

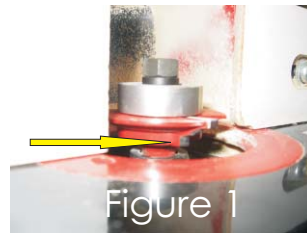

## Step 2

Match the bottom of the slot cutter on the bead cutter with the tongue of the first (cope) cut. (Figure 2) You may want to remove the material on this cut in two passes. This will give a cleaner finish.

Adjust your fence for the first cut and cut all of the bead profiles on your stiles and rails. Now adjust the fence for your second cut. Make sure that your fence is parallel and aligned to the inner most tips of the carbide. This point is above the slot cutter and flush with the carbide edge itself. (Figure 3)

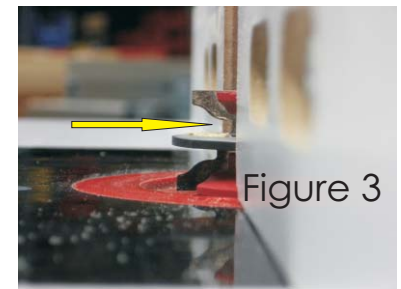
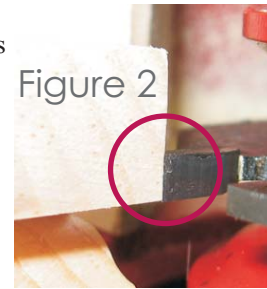

## Step 3

Once all of the moldings have been cut, use a 1/8" kerf saw blade to remove the extended profile on the bottom of all of the beaded parts. Save these recovered pieces for later insertion into the finished frame.

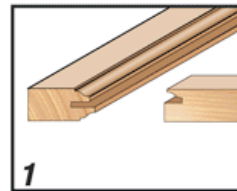

1 Cut profiles on stiles and rails using the Freud Recoverable Glass Door Bit Set

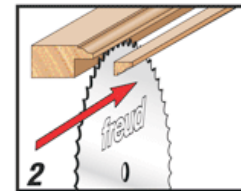

2 Remove beads with 1/8" kerf saw blade (10" Freud LM72 or LM74 Series recommended)



3 Assemble stiles and rails and miter cut beads to size

## Step 4

Assemble and glue your stiles and rails together. Allow to dry and measure for the glass insert. Allow 1/16" on top and bottom for seasonal wood movement. Place the glass insert into your frame.

## Step 5

Measure and mitre the recovered molding strips from step 3 at a 45 degree. Apply them around the inside back of the frame using small brad nails. (NOTE: do not glue these parts to the frame.) This allows you to remove the glass at a later date if it were to break and need replacing. These pieces are very small and fragile and may require pre-drill to avoid splitting.

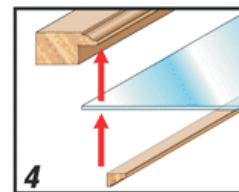

4 Install 1/8" glass and secure with beads

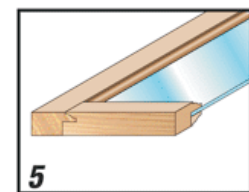

5 Now you have cabinet doors that look as good open as they do closed